

PROPOSED ALTERATIONS TO EXISTING RECYCLING CENTRE

23-43 & 45 TATTERSALL RD, KINGS PARK
LANDSCAPE

DRAWINGS

DWG NO.	DRAWING TITLE	SCALE
000	COVERSHEET	N/A
101	LANDSCAPE MASTERPLAN	1:500
401	LANDSCAPE PLAN	1:250
402	LANDSCAPE PLAN	1:250
403	LANDSCAPE PLAN	1:250
404	LANDSCAPE PLAN	1:250
501	LANDSCAPE DETAILS	AS SHOWN

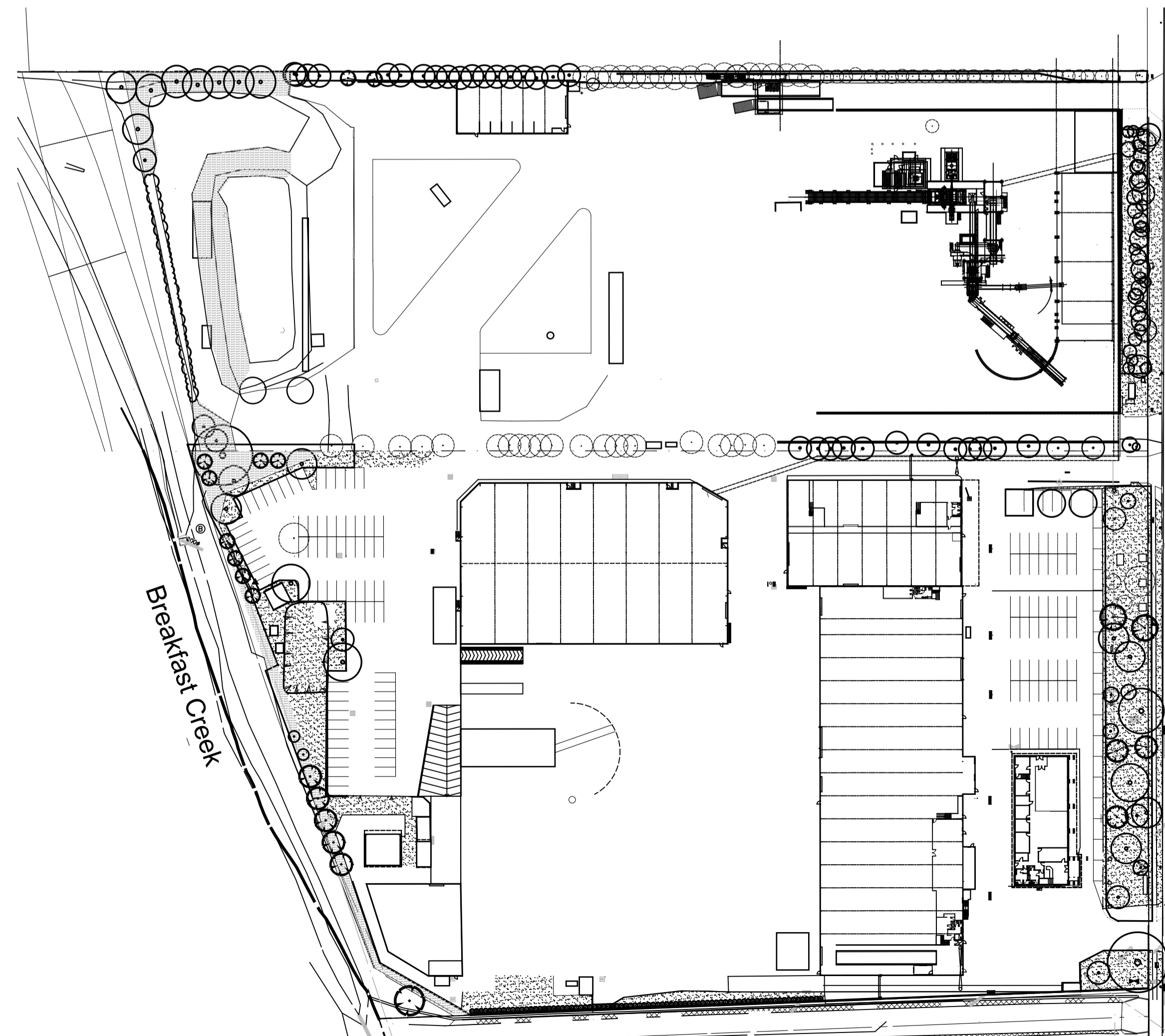

© 2016 Site Image (NSW) Pty Ltd ABN 44 801 262 380 as agent for Site Image NSW Partnership. All rights reserved. This drawing is copyright and shall not be reproduced or copied in any form or by any means (graphic, electronic or mechanical including photocopy) without the written permission of Site Image (NSW) Pty Ltd Any license, expressed or implied, to use this document for any purpose what so ever is restricted to the terms of the written agreement between Site Image (NSW) Pty Ltd and the instructing party.

The contractor shall check and verify all work on site (including work by others) before commencing the landscape installation. Any discrepancies are to be reported to the Project Manager or Landscape Architect prior to commencing work. Do not scale this drawing. Any required dimensions not shown shall be referred to the Landscape Architect for confirmation.

Issue	Revision Description	Drawn	Check	Date
I	LEC Amendments	JD	NM	22.09.2017
H	Revised carpark	JD	NM	15.08.2017
G	Revised for Fire Services	JW	NM	13.07.2017
F	Updated boundary/planting	JD	NM	10.11.2016
E	Revised Planting	JD	NM	18.10.2016
D	Construction certificate	SM	NM	04.10.2016
C	Construction certificate	JD	NM	23.03.2016
B	General Revisions	JW	NM	17.03.2016
A	For Comment	JW	NM	12.02.2016

LEGEND

Key Plan:

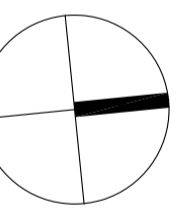

Client:

Sell and Parker Pty Ltd

Project:

Proposed Alterations to Existing Recycling Center
23 & 45 Tattersall Rd, Kings Park

Level 1, 3-5 Baptist Street
Rusdell NSW 2016
Australia
Tel: (61 2) 8332 5600
Fax: (61 2) 9698 2677
www.siteimage.com.au
Site Image (NSW) Pty Ltd
ABN 44 801 262 380

SITE IMAGE



Landscape Architects

CONSTRUCTION CERTIFICATE

Drawing Name:

Coversheet

Scale:

Job Number:

SS15-3178

Drawing Number:

Issue:

000 I

NOT FOR CONSTRUCTION

The contractor shall check and verify all work on site (including work by others) before commencing the landscape installation. Any discrepancies are to be reported to the Project Manager or Landscape Architect prior to commencing work. Do not scale this drawing. Any required dimensions not shown shall be referred to the Landscape Architect for confirmation.

J	LEC Amendments	JD	NM	22.09.2017
I	Revised carpark	JD	NM	15.08.2017
H	Revised for Fire Services	JW	NM	13.07.2017
G	Updated boundary/planting	SM	NM	31.01.2017
F	Updated boundary/planting	JD	NM	10.11.2016
E	Revised Planting	JD	NM	18.10.2016
D	Construction certificate	SM	NM	04.10.2016
C	Construction certificate	JD	NM	23.03.2016
B	General Revisions	JW	NM	17.03.2016
A	For Comment	JW	NM	12.02.2016
Issue	Revision Description	Drawn	Check	Date

- LEGEND**
- Site Boundary
 - Existing vegetation to be retained, with additional interplanted vegetation
 - Turf
 - Existing tree to be removed
 - Existing tree to be retained
 - Proposed tree planting

Key Plan:

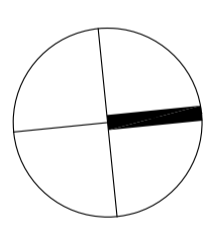

Client:
Sell and Parker Pty Ltd

Project:
**Proposed Alterations to Existing Recycling Center
23 & 45 Tattersal Rd, Kings Park**

Level 1, 3-5 Baptist Street
Rusdell NSW 2016
Australia
Tel: (61 2) 8332 5600
Fax: (61 2) 9598 2677
www.siteimage.com.au
Site Image (NSW) Pty Ltd
ABN 44 801 262 380



CONSTRUCTION CERTIFICATE

Drawing Name:
Landscape Masterplan

Scale: 1:500 @ A1
Job Number:
Drawing Number:
Issue:

SS15-3178 101 J

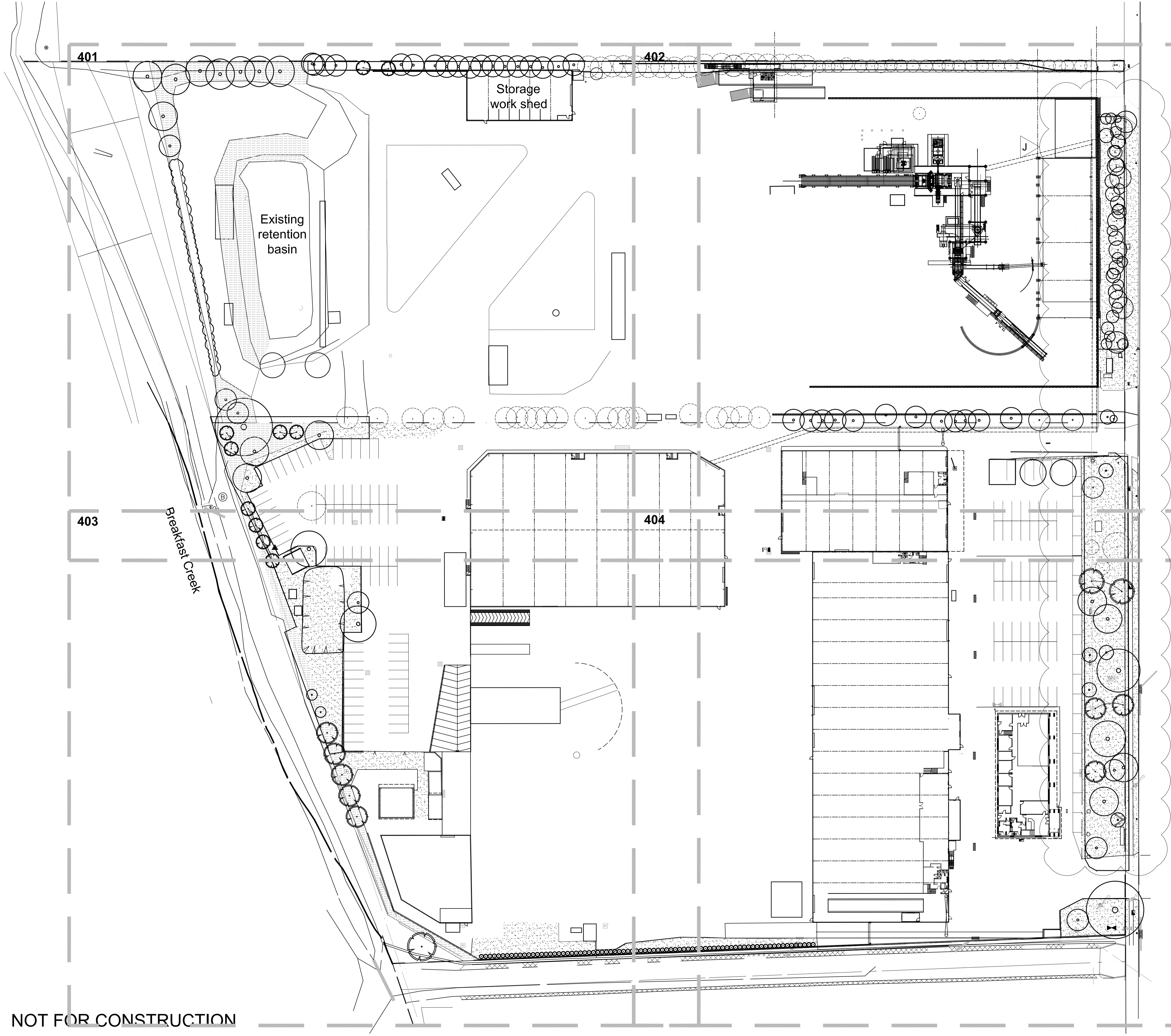

NOT FOR CONSTRUCTION

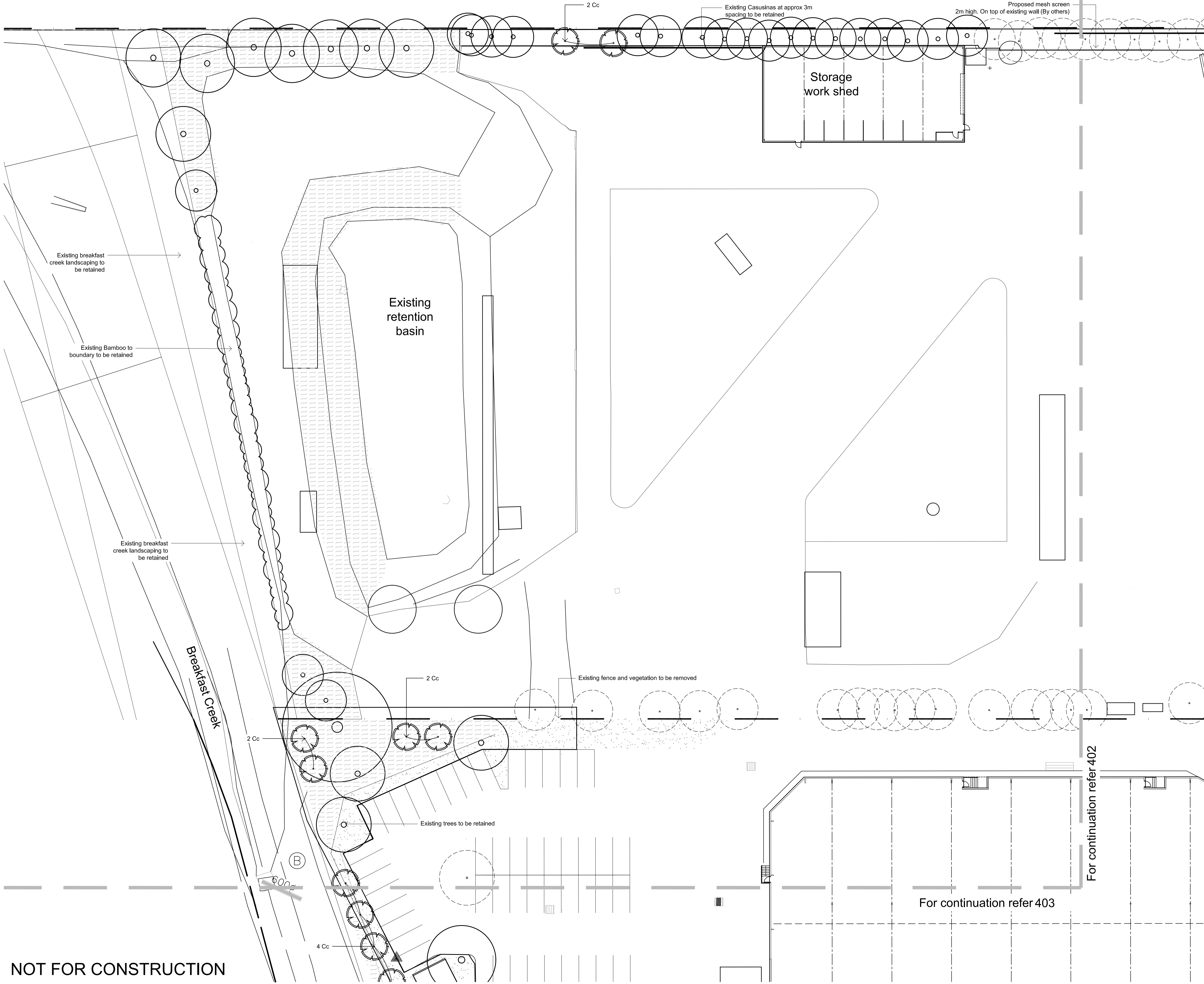

© 2016 Site Image (NSW) Pty Ltd ABN 44 801 262 380 as agent for Site Image NSW Partnership. All rights reserved. This drawing is copyright and shall not be reproduced or copied in any form or by any means (graphic, electronic or mechanical including photocopy) without the written permission of Site Image (NSW) Pty Ltd Any license, expressed or implied, to use this document for any purpose what so ever is restricted to the terms of the written agreement between Site Image (NSW) Pty Ltd and the instructing party.

The contractor shall check and verify all work on site (including work by others) before commencing the landscape installation. Any discrepancies are to be reported to the Project Manager or Landscape Architect prior to commencing work. Do not scale this drawing. Any required dimensions not shown shall be referred to the Landscape Architect for confirmation.

G	Revised carpark	JD	NM	15.08.2017
F	Updated boundary/landscaping	JD	NM	10.11.2016
E	Revised Planting	JD	NM	18.10.2016
D	Construction certificate	SM	NM	04.10.2016
C	Construction certificate	JD	NM	23.03.2016
B	General Revisions	JW	NM	17.03.2016
A	For Comment	JW	NM	12.02.2016
Issue	Revision Description	Drawn	Check	Date

- LEGEND**
- Site Boundary
 - Existing vegetation to be retained, with additional interplanted vegetation
 - Turf
 - Existing tree to be removed
 - Existing tree to be retained
 - Proposed tree planting

Key Plan:

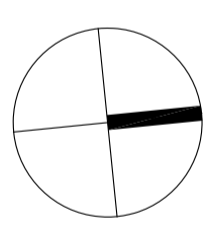

Client:
Sell and Parker Pty Ltd

Project:
**Proposed Alterations to Existing Recycling Center
23 & 45 Tattersal Rd, Kings Park**

SITE IMAGE
Level 1, 3-5 Baptist Street
Rusdell NSW 2016
Australia
Tel: (61 2) 8332 5600
Fax: (61 2) 9598 2677
www.siteimage.com.au
Site Image (NSW) Pty Ltd
ABN 44 801 262 380



CONSTRUCTION CERTIFICATE

Drawing Name:
Landscape Plan

Scale: 1:250 @ A1
Job Number:
Drawing Number:
Issue:

SS15-3178 401 G

NOT FOR CONSTRUCTION

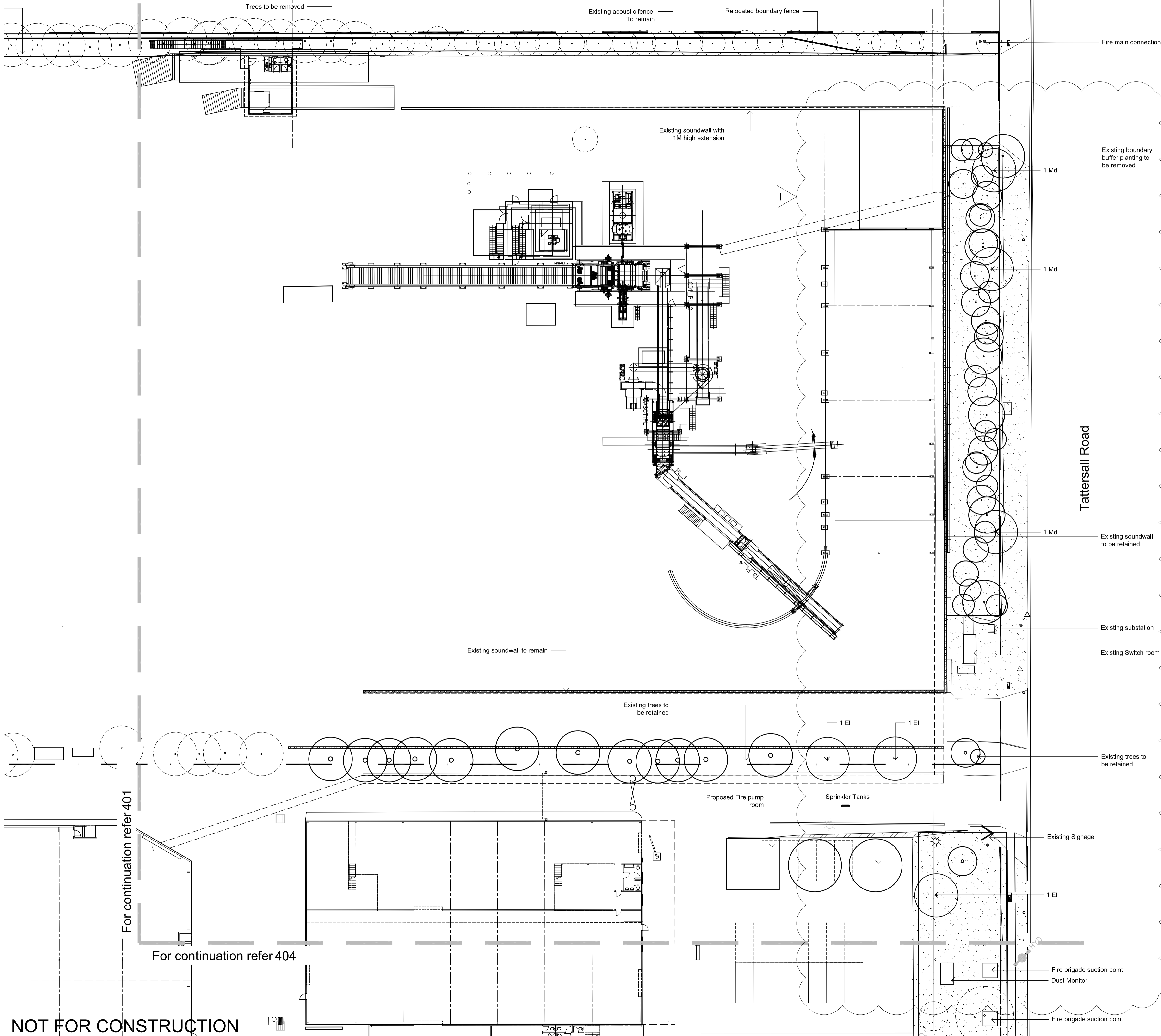

© 2016 Site Image (NSW) Pty Ltd. All rights reserved. This drawing is copyright and shall not be reproduced or copied in any form or by any means (graphic, electronic or mechanical including photocopy) without the written permission of Site Image (NSW) Pty Ltd. Any license, expressed or implied, to use this document for any purpose whatsoever is restricted to the terms of the written agreement between Site Image (NSW) Pty Ltd and the instructing party.

The contractor shall check and verify all work on site (including work by others) before commencing the landscape installation. Any discrepancies are to be reported to the Project Manager or Landscape Architect prior to commencing work. Do not scale this drawing. Any required dimensions not shown shall be referred to the Landscape Architect for confirmation.

I	LEC Amendments	JD	NM	22.09.2017
H	Revised for Fire Services	JW	NM	13.07.2017
G	Updated boundary planting	SM	NM	31.01.2017
F	Updated boundary planting	JD	NM	10.11.2016
E	Revised Planting	JD	NM	18.10.2016
D	Construction certificate	SM	NM	04.10.2016
C	Construction certificate	JD	NM	23.03.2016
B	General Revisions	JW	NM	17.03.2016
A	For Comment	JW	NM	12.02.2016
Issue	Revision Description	Drawn	Check	Date

- LEGEND**
- Site Boundary
 - Existing vegetation to be retained, with additional interplanted vegetation
 - Turf
 - Existing tree to be removed
 - Existing tree to be retained
 - Proposed tree planting

Key Plan:

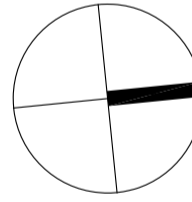

Client:
Sell and Parker Pty Ltd

Project:
**Proposed Alterations to Existing Recycling Center
23 & 45 Tattersall Rd, Kings Park**

SITE IMAGE
Level 1, 3-5 Baptist Street
Rusdell NSW 2016
Australia
Tel: (61 2) 8332 5600
Fax: (61 2) 9598 2677
www.siteimage.com.au
Site Image (NSW) Pty Ltd
ABN 44 601 262 360



CONSTRUCTION CERTIFICATE

Drawing Name:
Landscape Plan

Scale: 1:250 @ A1

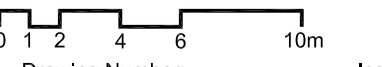

Job Number:
SS15-3178

Issue:
402 I

NOT FOR CONSTRUCTION

The contractor shall check and verify all work on site (including work by others) before commencing the landscape installation. Any discrepancies are to be reported to the Project Manager or Landscape Architect prior to commencing work. Do not scale this drawing. Any required dimensions not shown shall be referred to the Landscape Architect for confirmation.

G	Revised carpark	JD	NM	15.08.2017
F	Updated boundary/planting	JD	NM	10.11.2016
E	Revised Planting	JD	NM	18.10.2016
D	Construction certificate	SM	NM	04.10.2016
C	Construction certificate	JD	NM	23.03.2016
B	General Revisions	JW	NM	17.03.2016
A	For Comment	JW	NM	12.02.2016
Issue	Revision Description	Drawn	Check	Date

LEGEND

[Symbol]	Site Boundary
[Symbol]	Existing vegetation to be retained, with additional interplanted vegetation
[Symbol]	Turf
[Symbol]	Existing tree to be removed
[Symbol]	Existing tree to be retained
[Symbol]	Proposed tree planting

Key Plan:

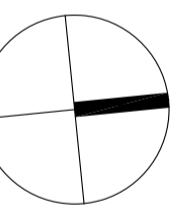

Client:
Sell and Parker Pty Ltd

Project:
**Proposed Alterations to Existing Recycling Center
23 & 45 Tattersal Rd, Kings Park**

Level 1, 3-5 Baptist Street
Radford NSW 2016
Australia

Tel: (61 2) 8332 5600
Fax: (61 2) 9698 2677
www.siteimage.com.au

Site Image (NSW) Pty Ltd
ABN 44 801 262 380

SITE IMAGE



Landscape Architects

CONSTRUCTION CERTIFICATE

Drawing Name:
Landscape Plan

Scale: 1:250 @ A1
Job Number:

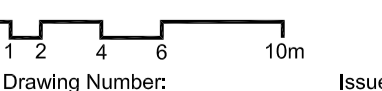

SS15-3178

403 G

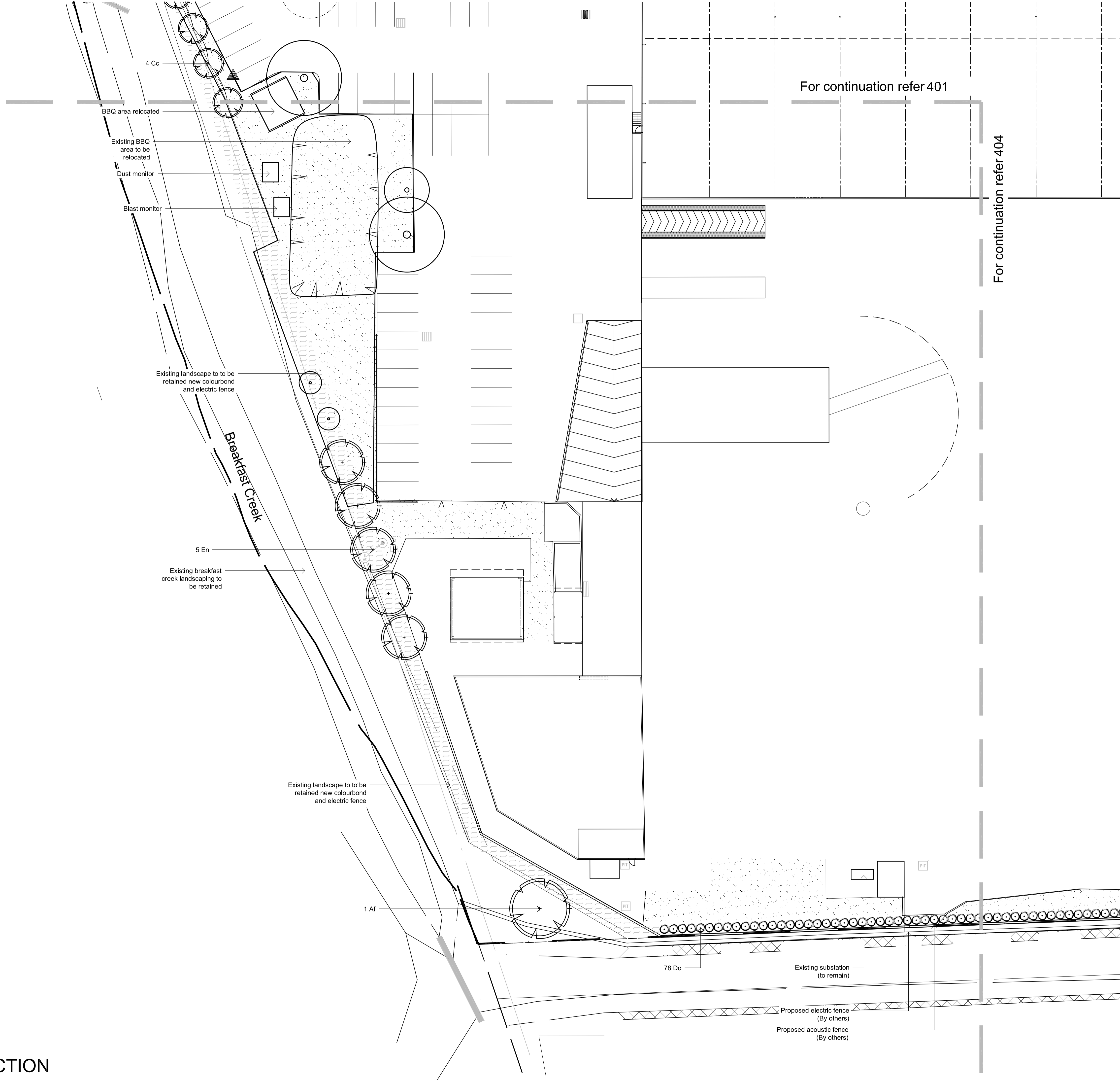

NOT FOR CONSTRUCTION

© 2016 Site Image (NSW) Pty Ltd. All rights reserved. This drawing is copyright and shall not be reproduced or copied in any form or by any means (graphic, electronic or mechanical including photocopy) without the written permission of Site Image (NSW) Pty Ltd. Any license, expressed or implied, to use this document for any purpose what so ever is restricted to the terms of the written agreement between Site Image (NSW) Pty Ltd and the instructing party.

The contractor shall check and verify all work on site (including work by others) before commencing the landscape installation. Any discrepancies are to be reported to the Project Manager or Landscape Architect prior to commencing work. Do not scale this drawing. Any required dimensions not shown shall be referred to the Landscape Architect for confirmation.

G	LEC Amendments	JD	NM	22.09.2017
F	Updated boundary/planting	JD	NM	10.11.2016
E	Revised Planting	JD	NM	18.10.2016
D	Construction certificate	SM	NM	04.10.2016
C	Construction certificate	JD	NM	23.03.2016
B	General Revisions	JW	NM	17.03.2016
A	For Comment	JW	NM	12.02.2016
Issue	Revision Description	Drawn	Check	Date

LEGEND

	Site Boundary
	Existing vegetation to be retained, with additional interplanted vegetation
	Turf
	Existing tree to be removed
	Existing tree to be retained
	Proposed tree planting

Key Plan:

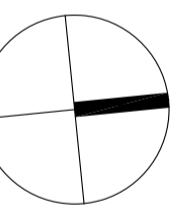

Client:
Sell and Parker Pty Ltd

Project:
**Proposed Alterations to Existing Recycling Center
23 & 45 Tattersal Rd, Kings Park**

SITE IMAGE
Level 1, 3-5 Baptist Street
Rusdell NSW 2016
Australia
Tel: (61 2) 8332 5600
Fax: (61 2) 9598 2677
www.siteimage.com.au
Site Image (NSW) Pty Ltd
ABN 44 601 262 360
 Landscape Architects

CONSTRUCTION CERTIFICATE

Drawing Name:
Landscape Plan

Scale: 1:250 @ A1
Job Number: SS15-3178
Drawing Number: 404
Issue: G

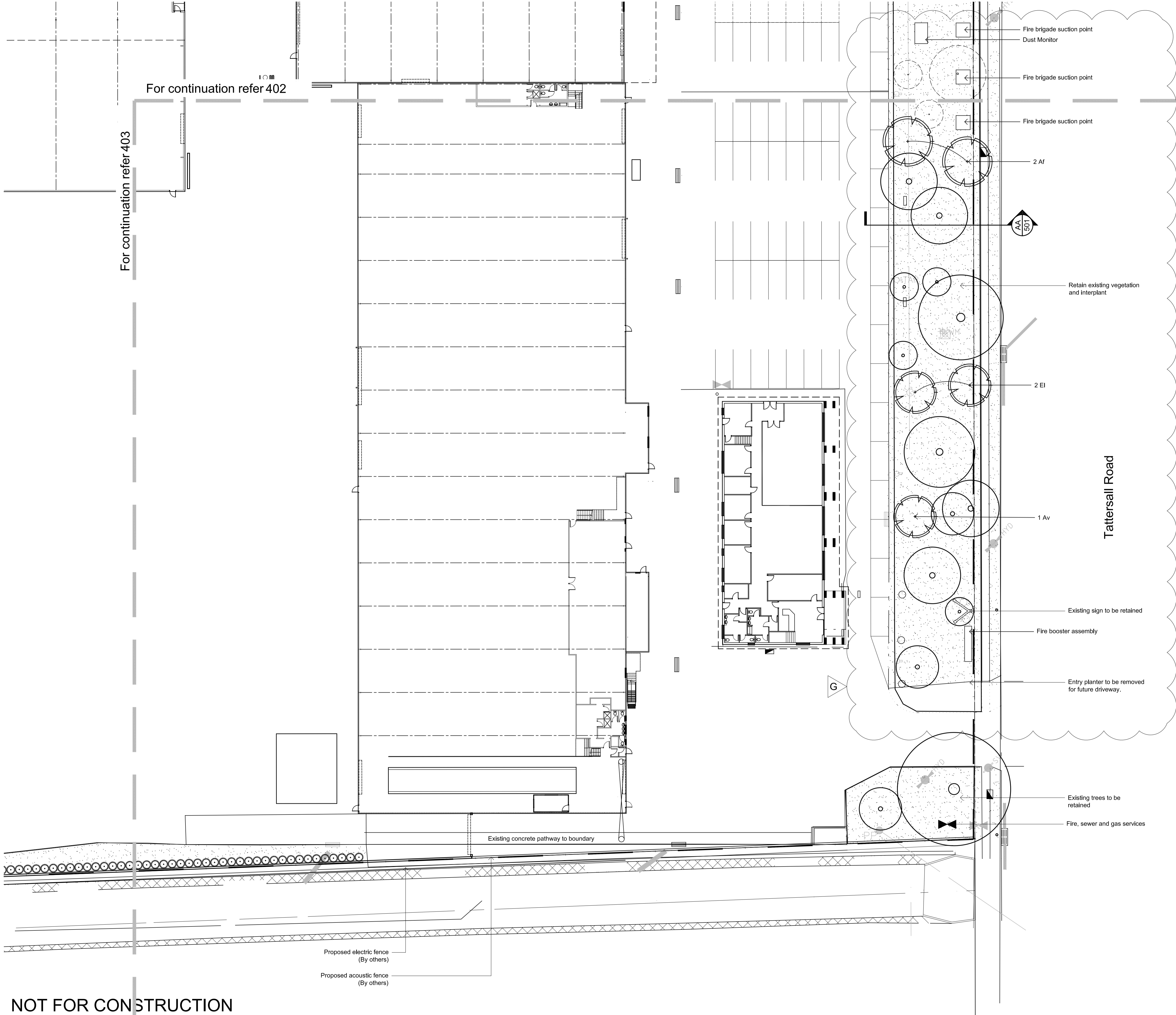

For continuation refer 402

For continuation refer 403

NOT FOR CONSTRUCTION

The contractor shall check and verify all work on site (including work by others) before commencing the landscape installation. Any discrepancies are to be reported to the Project Manager or Landscape Architect prior to commencing work. Do not scale this drawing. Any required dimensions not shown shall be referred to the Landscape Architect for confirmation.

I	LEC Amendments	JD	NM	22.09.2017
H	Revised for Fire Services	JW	NM	13.07.2017
G	Updated boundary planting	SM	NM	31.01.2017
F	Updated boundary planting	JD	NM	10.11.2016
E	Revised Planting	JD	NM	18.10.2016
D	Construction certificate	SM	NM	04.10.2016
C	Construction certificate	JD	NM	23.03.2016
B	General Revisions	JW	NM	17.03.2016
A	For Comment	JW	NM	12.02.2016
Issue	Revision Description	Drawn	Check	Date

LEGEND

Key Plant:

Client:

Sell and Parker Pty Ltd

Project:

**Proposed Alterations to Existing Recycling Center
23 & 45 Tattersal Rd, Kings Park**

S I T E I M A G E

Level 1, 3-5 Baplist Street
Rusdell NSW 2016
Australia

Tel: (61 2) 8332 5600
Fax: (61 2) 9698 2677
www.siteimage.com.au

Site Image (NSW) Pty Ltd
ABN 44 901 262 360



Landscape Architects

CONSTRUCTION CERTIFICATE

Drawing Name:

Landscape Details

Scale: 1:250 @ A1

Job Number:

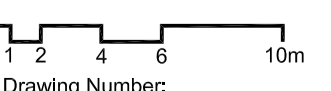

Drawing Number:

Issue:

SS15-3178

501 |

Maintenance Schedule

Table	ACTIVITY	FREQUENCY						ACTION
		D	W	2W	3W	M	3or6M	
1	Logbook	+		+		+		Daily, Weekly, Monthly Complete a logbook entry every day at site and at least every two weeks. All actions listed below require a logbook entry. Upon request, make the logbook available for inspection. Submit copies of new entries in the logbook to the Contract Administrator on a monthly basis. Please note that more frequent, short, occasional inspection should result in less maintenance work when problems are observed earlier than they might otherwise have been seen. Maintenance requirements should extend for a minimum of two years after the completion of works or until such time as a minimum 80% survival rate for all plantings and a maximum five percent (5%) weed cover for the treated riparian corridor (controlled activity) is achieved. Maps or diagrams which identify the proposed riparian area, existing vegetation, vegetation to be retained, vegetation to be cleared, footprint of construction activities, areas of proposed revegetation etc should be prepared.
2	Plant replacement			+		+		Inspect and replace failed plants within 2 weeks of observation of failure. Match species, size (original) and location of new with old.
3	Mulch			+		+		Inspect and replace mulch deficiencies within 2 weeks of observation. Prior to placing new mulch aerate the soil by fork turning to a depth of at least 100mm, roughly level the soil and then place mulch. Do not disturb major plant roots while aerating soil. It can be expected that mulch will have significantly broken-down after an estimated 12-month period following initial application. It is therefore recommended that all mulch beds are topped-up with a 50mm layer of woodchip/leaf mulch (Compliant with AS 4454) at this stage. This should be accompanied by a topdressing application of a 9-month, slow release, low phosphorous fertiliser to ensure that semi-established plantings do not suffer as a result of potential nitrogen draw-down that may be associated with the application of the 50mm mulch layer at the 12-month period.
4	Erosion control			+				Inspect every two weeks and repair ground, soil and mulch immediately. Maintain erosion control device as necessary. Silt fencing installed for sediment control purposes to the east of the tributary. Silt fencing should be regularly inspected and repaired or reinstalled as necessary.
5	Stakes and ties			+				Inspect every two weeks, adjust and/or replace as necessary but remove as plants mature and are able to support themselves.
6	Weed and rubbish removal			+				Inspect and remove immediately upon observation. Leave no waste on site. Dispose of waste material at a designated waste disposal site. All herbaceous weeds should be managed to be at very-low percentage cover levels, (as a minimum), or better. Pasture grasses should be prevented from spreading into any bushland zones by applying a spot glyphosate herbicide spray application on the 1-metre wide buffer zone, on a monthly basis or as required. Maintenance weeding for a period of 24 months after the completion of primary works with an increase in maintenance hours occurring throughout the warmer growing months.
7	Pruning			+				Inspect every 2 weeks and prune as necessary to remove dead wood, improve plant shape and promote healthy vigorous new growth.
8	Spraying			+				Inspect every 2 weeks and action as necessary. Do not spray if other non-chemical methods will satisfy the need to remove insects. Spray for disease control only when absolutely necessary.
9	Urgent works		+					Complete within 1 week (7 days) of notification. Inspect and clear drains.
10	Planting and fertilising			+			3m+	Inspect every 2 weeks and remove spent flowers and dead stalks as they become apparent. Fertilise gardens every 3 months or other frequency in accordance with fertiliser manufacturer's directions.
11	Watering	+		+				Water when and where necessary every day at site and at least every 2 weeks generally. Do not allow soil and plants to dehydrate. Allow for prolonged rain, windy and dry periods. Water in the early morning or late afternoon to avoid excessive evaporation during the heat of the day.
12	Mowing, top-dressing and edging			+		+	6m+	Summer fortnightly. Winter monthly. Top-dress 6 monthly.

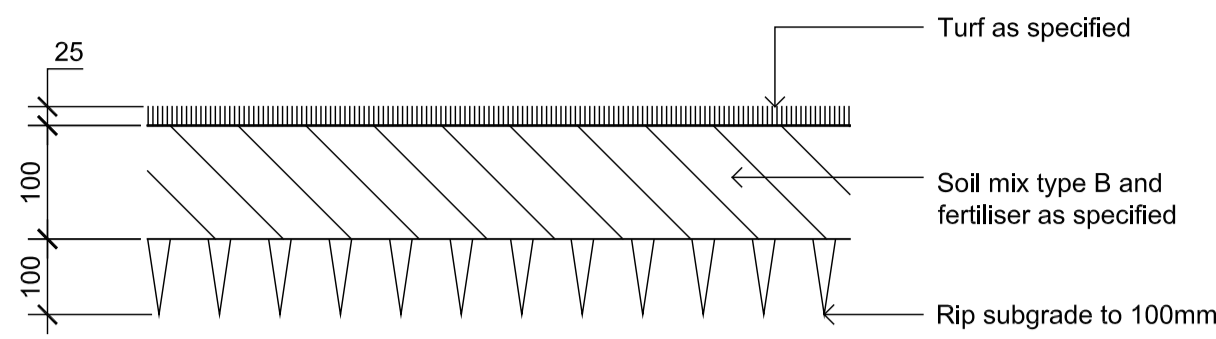

**DETAIL -TURF ON EVEN GRADE
1:10**

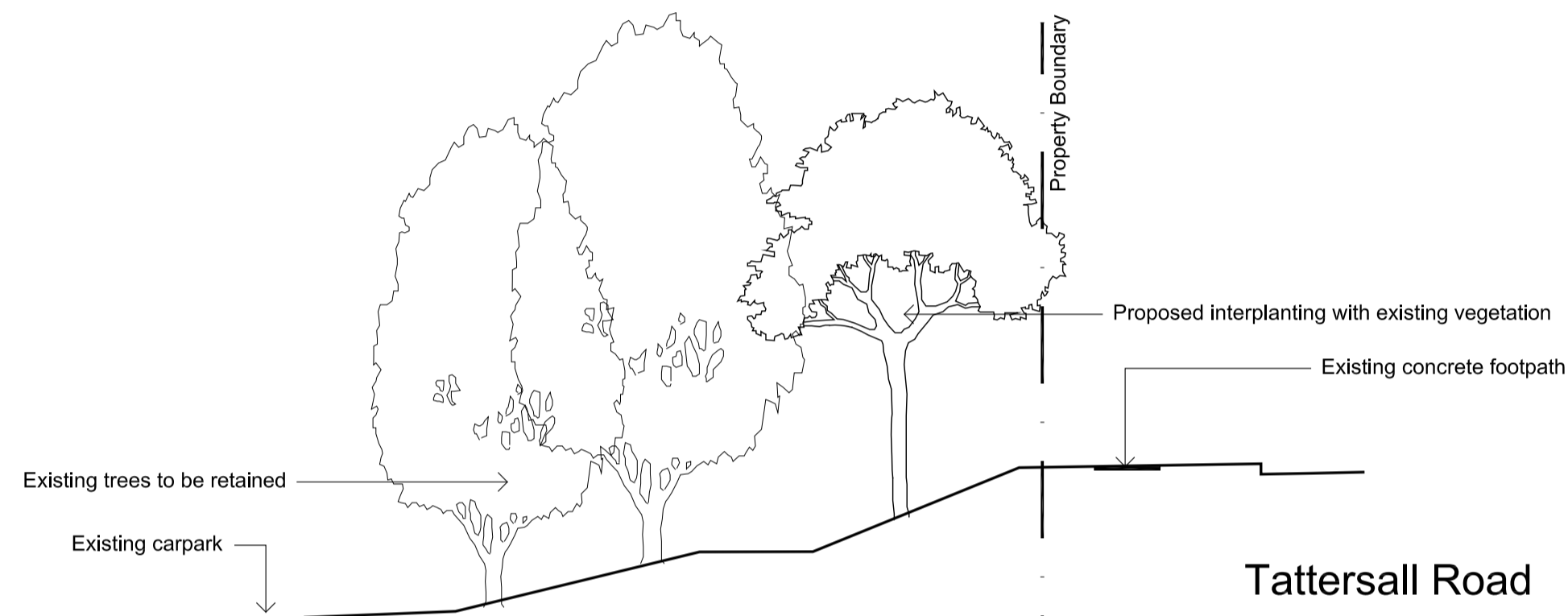

**SECTION AA
SCALE 1:100**

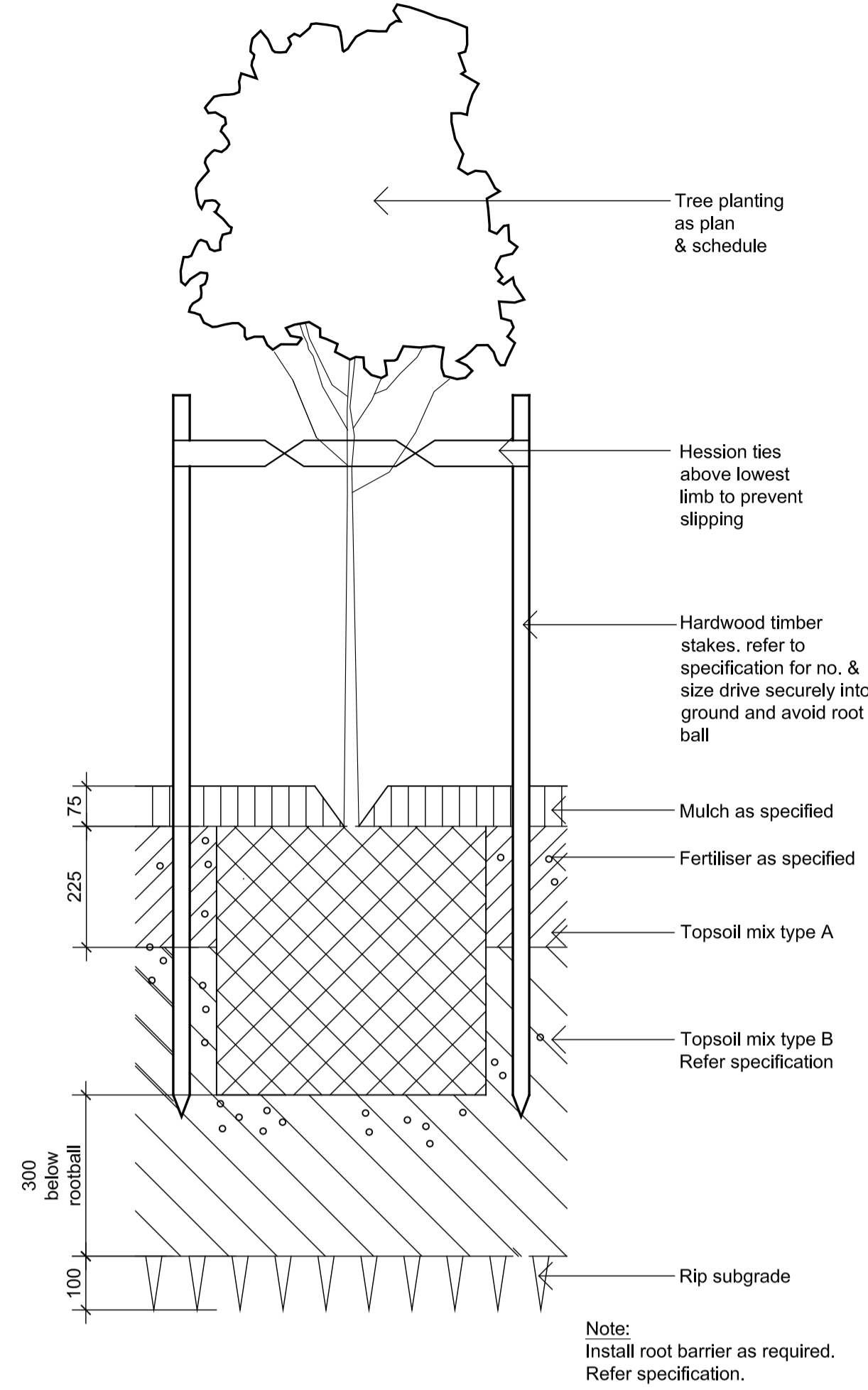

**DETAIL - 75-200L TREE PLANTING ON GRADE
1:10**

Symbol	Botanic Name	Common Name	Mature Size (h x w)	Pot Size	Spacing	Qty
TREES						
Af	<i>Angophora floribunda</i>	Rough-Barked Apple	20 x 8	100L	As Shown	3
Av	<i>Allocasuarina verticillata</i>	Drooping She-Oak	8 x 7	100L	As Shown	1
Cc	<i>Casuarina cunninghamiana</i>	River Sheoak	20 x 6	100L	As Shown	10
Ei	<i>Eucalyptus leucoxylon 'Eukie Dwarf'</i>	Eukie Dwarf	7 x 5	100L	As Shown	5
En	<i>Eucalyptus nicholii</i>	Willow Peppermint	12 x 9	100L	As Shown	5
Md	<i>Melaleuca decora</i>	White Feather Honey Myrtle	6 x 3	100L	As Shown	3
BAMBOO						
Do	<i>Dendrocalamopsis oldhamii</i>	Giant Timber Bamboo	15 x 2	300mm	As Shown	78